

# CABLE CLAMP

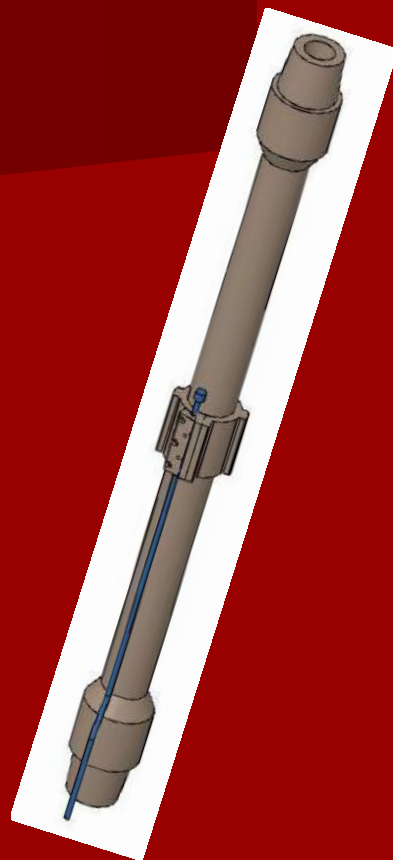
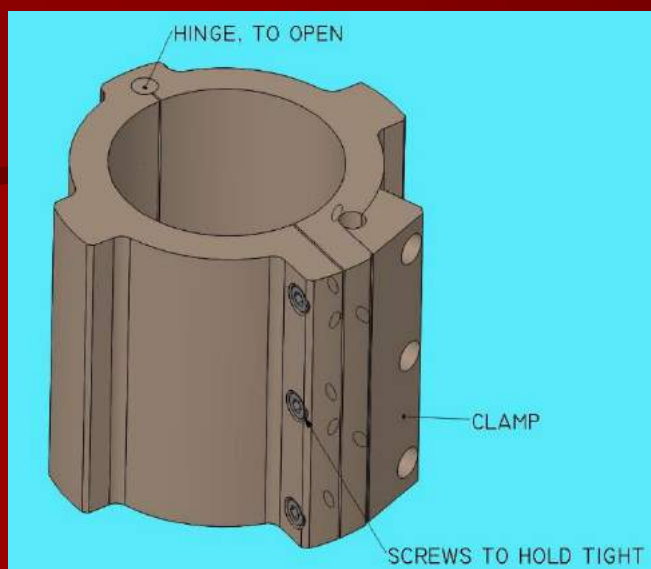

**Operators need to have device that can be used to “quickly” clamp a wireline cable to a drill pipe and avoid the cable from slipping down and falling into the well.**

**The design of our CABLE CLAMP is based on our 40 years’ experience in Pipe Conveyed Tools.**

**This Cable Clamp is easy to use and robust.**

**It comes in different sizes (depending on the DP and logging cable dimensions).**